



Hot Tap Operating Instructions

Attach a service saddle (1) to the main in accordance with the manufacturer's specifications. Tightly screw a corporation stop (2) into the saddle. Ensure that it is in the OPEN position.

Select the proper valve adaptor (3) and attach it to the Mini-Tap. Select the proper cutter/drill and adaptor shaft and attach to the drive shaft of the Mini-Tap.

Attach the Mini-Tap machine to the outlet thread of the corporation stop.

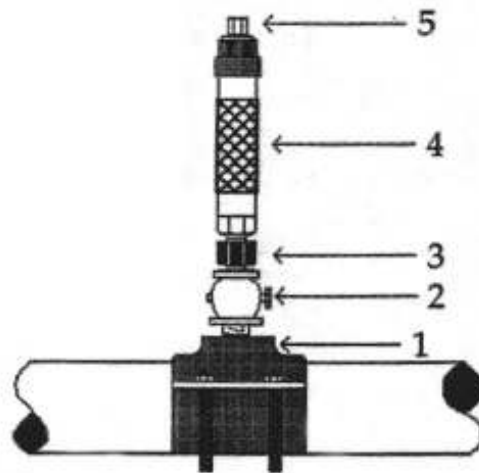

Turn the feed (4) clockwise until the cutter comes into contact with the main. Using the ratchet wrench, rotate the drive shaft at the hex drive (5) while continually applying pressure [by turning sleeve (4)]. Drill through the main until no resistance is felt when advancing the feed.

When the hole is drilled through the main, turn the feed (4) counter-clockwise until all the threads are exposed.

Lift the body of the Mini-Tap up until the cutter assembly is above the corporation stop. Close the valve on the corporation stop (2).

The tap is now complete. Remove the machine from the corporation stop.

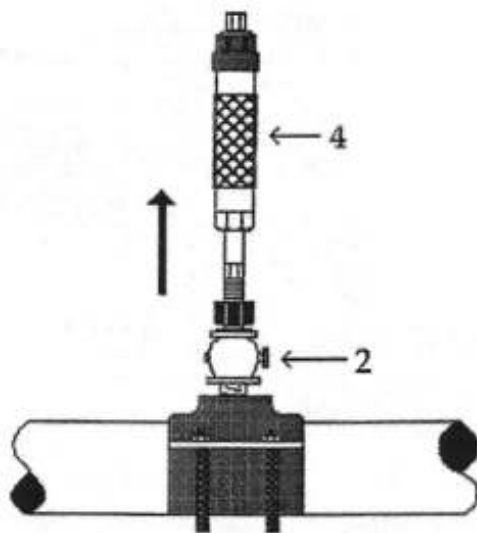

Notes: When drilling PVC pipe, the drive shaft should be rotated in a smooth continuous motion. Do not apply too much pressure on the cutter and pipe with the feed screw. Gentle light pressure applied with the feed will produce superior cutting characteristics.

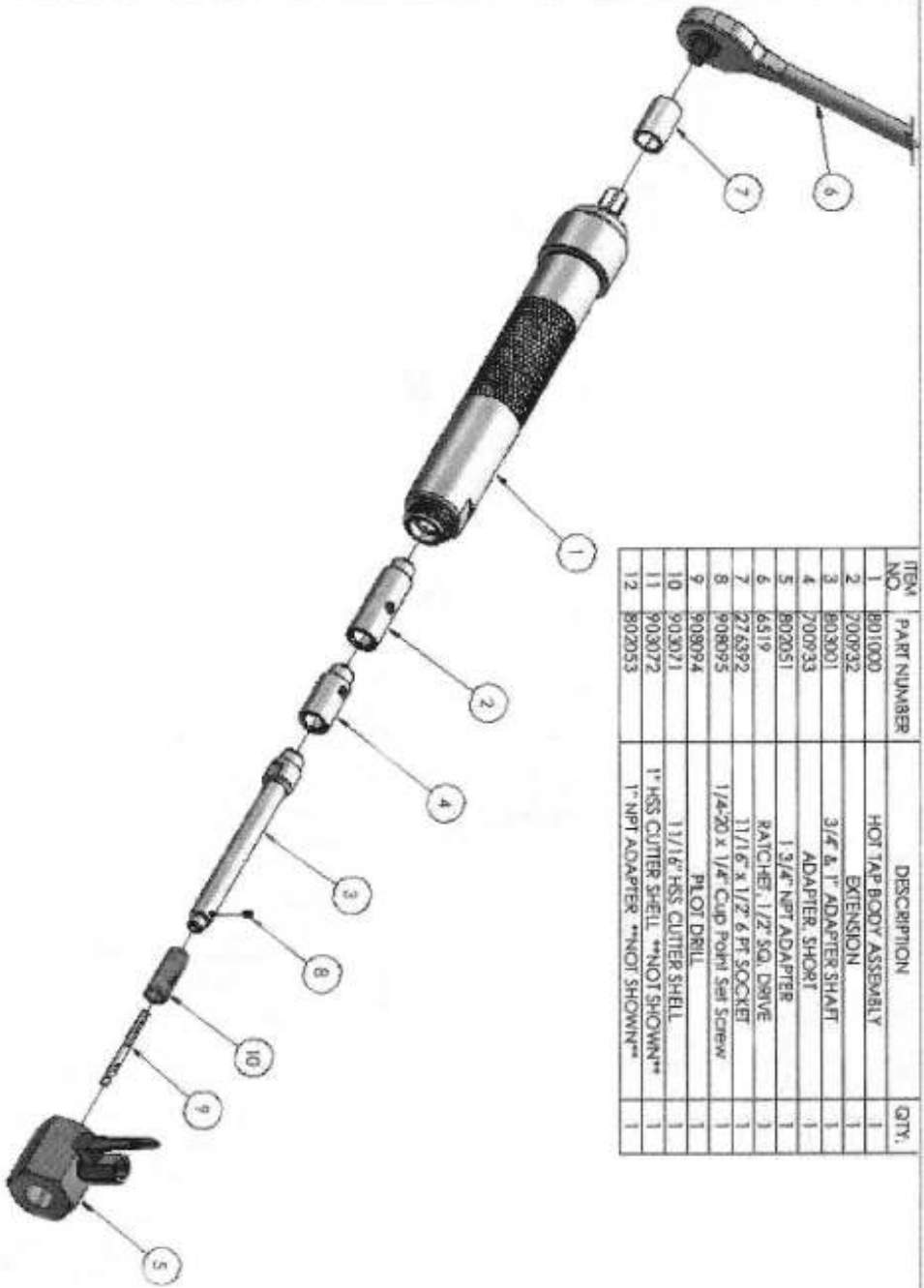

ITEM NO.	PART NUMBER	DESCRIPTION	QTY.
1	801000	HOT TAP BODY ASSEMBLY	1
2	700932	EXTENSION	1
3	803001	3/4" & 1" ADAPTER SHAFT	1
4	700933	ADAPTER, SHORT	1
5	802051	1 3/4" NPT ADAPTER	1
6	6519	RATCHET, 1/2" SQ. DRIVE	1
7	276392	11/16" X 1/2" 6 FT. SOCKET	1
8	908095	1/4-20 X 1/4" Cup Point Self Screw	1
9	908094	PLLOT DRILL	1
10	903071	11/16" HSS CUTTER SHLL	1
11	903072	1" HSS CUTTER SH-ELL **NOT SHOWN**	1
12	802053	1" NPT ADAPTER **NOT SHOWN**	1

 3744 Jefferson Rd., Astoria, OR 97103
 GSC-888-006
 DRILLING MACHINE, 3/4" & 1" NPT
 PART NO. 8100

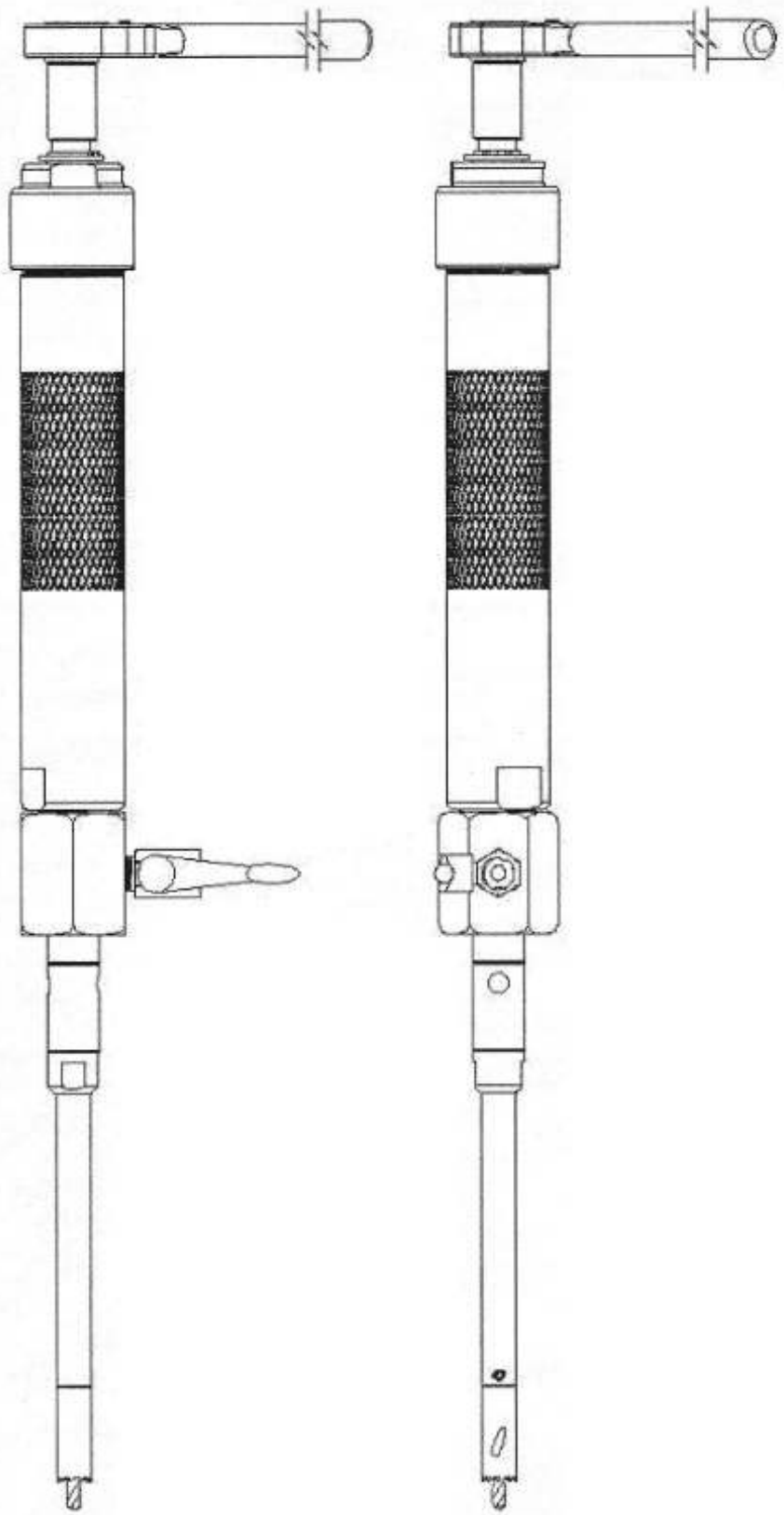

WHEELER
REX
3744 Jefferson Rd., Ashland, OH 44805
DECEMBER 1970
DRILLING MACHINE, 3/4" & 1" NPT
PART NO. 8100

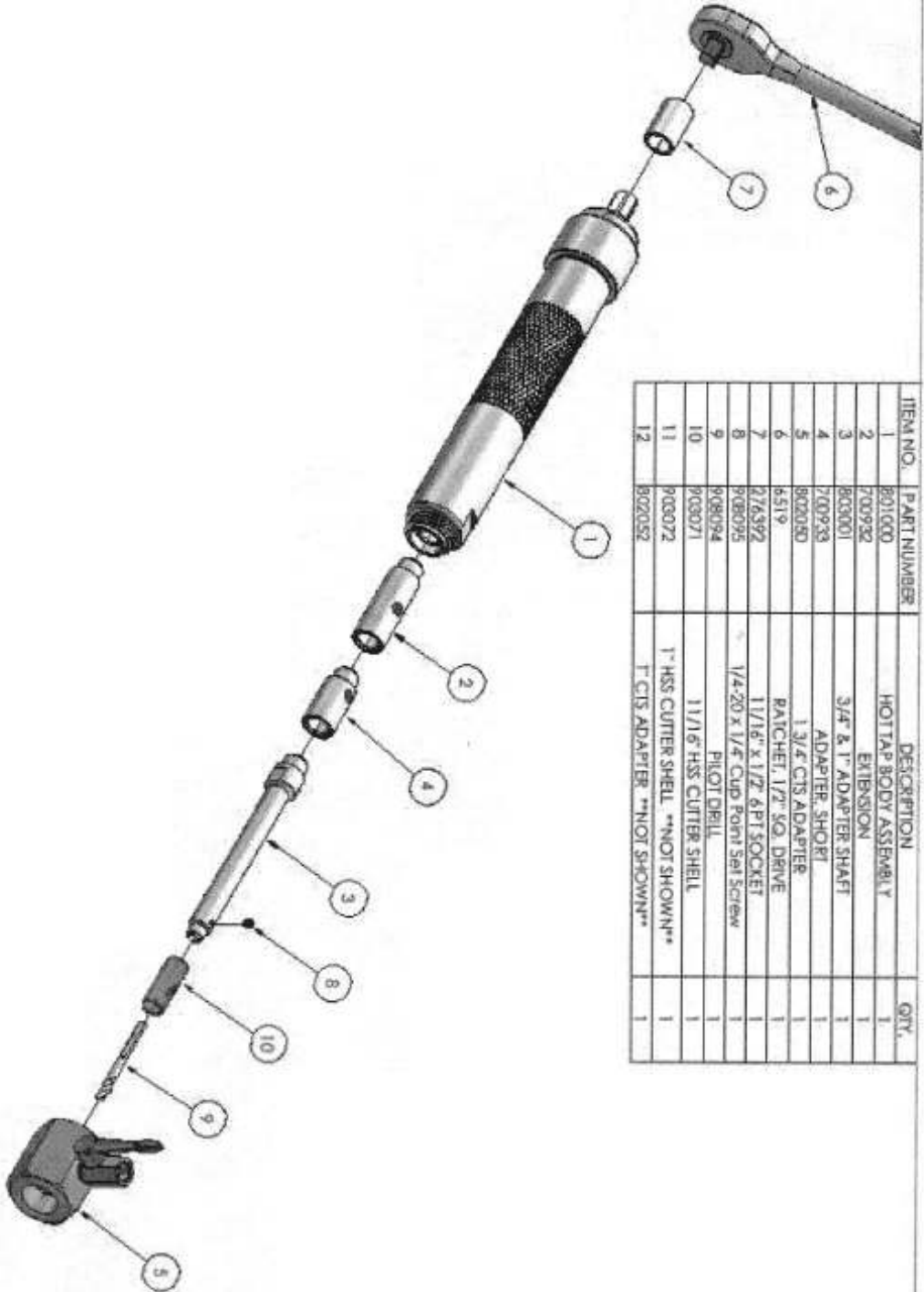

ITEM NO.	PART NUMBER	DESCRIPTION	QTY.
1	801000	HOT TAP BODY ASSEMBLY	1
2	700932	EXTENSION	1
3	803001	3/4" & 1" ADAPTER SHAFT	1
4	700933	ADAPTER, SHORT	1
5	802090	1 3/4" CTS ADAPTER	1
6	6519	RATCHET, 1/2" SQ. DRIVE	1
7	276392	1 1/16" x 1/2" 6PT SOCKET	1
8	908095	1/4-20 x 1/4" Cup Point Set Screw	1
9	908094	PILOT DRILL	1
10	903071	1 1/16" HSS CUTTER SHELL	1
11	903072	1" HSS CUTTER SHELL **NOT SHOWN**	1
12	802052	T" CTS ADAPTER **NOT SHOWN**	1

WHEELER
REX

3744 Jefferson Rd., Avon Lake, OH 44005
 DESCRIPTION: DRILLING MACHINE, 3/4" & 1" CTS
 PART NO: **8200**

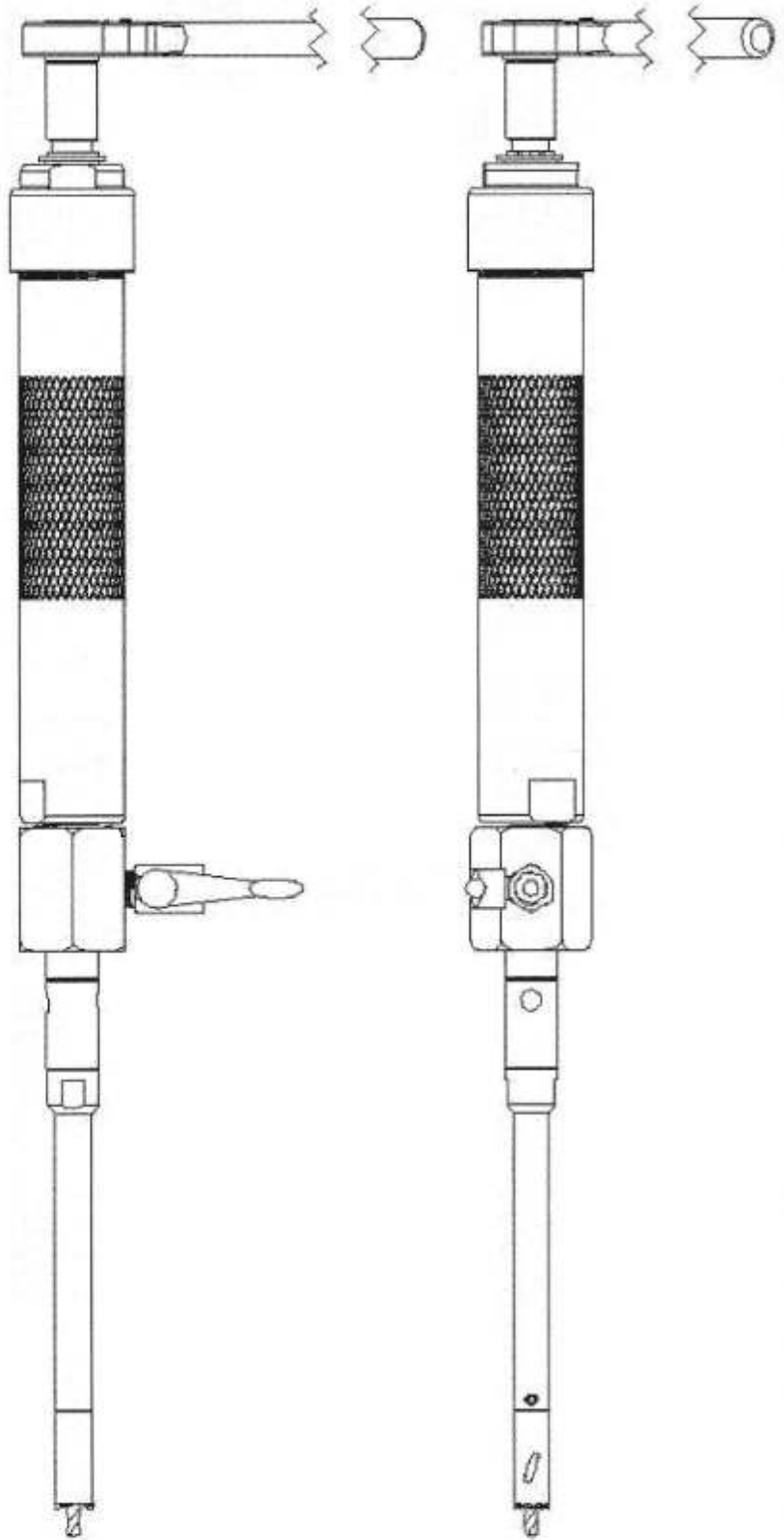

WHEELER
RÉX

37 44 Jefferson St., Anderson, OH 46016
DESCRIPTION:
DRILLING MACHINE, 3/4" & 1" CTS
PART NO. 8200